

# Manual D30

A few words about the building .....

- I recommend a layer of 0.2 mm, just 20% fill.
- I use PLA filament.
- For tires use 5% infill and you must use flex filament

You need:

- Screw M2x5mm – 20pcs
- Screw M2x10mm – 20pcs
- Screw M3x16mm – 10pcs
- Screw M3x20mm – 10pcs
- Screw M3x40mm – 10pcs

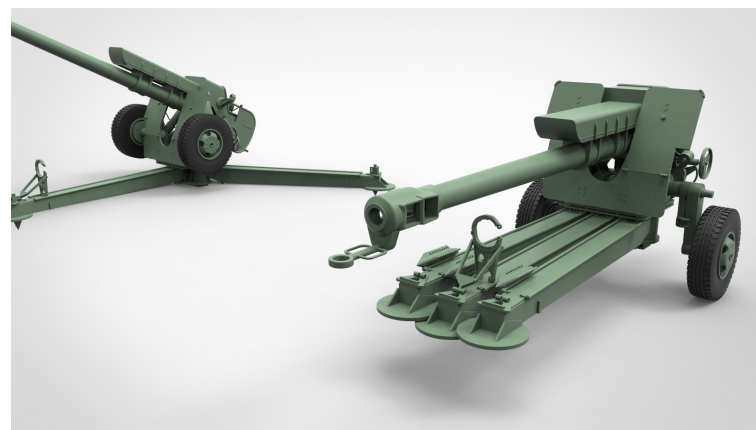

# Step 1

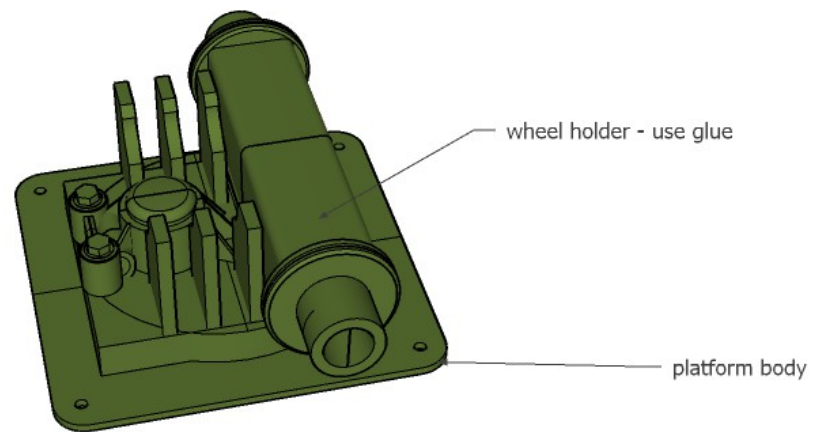

# Step 2

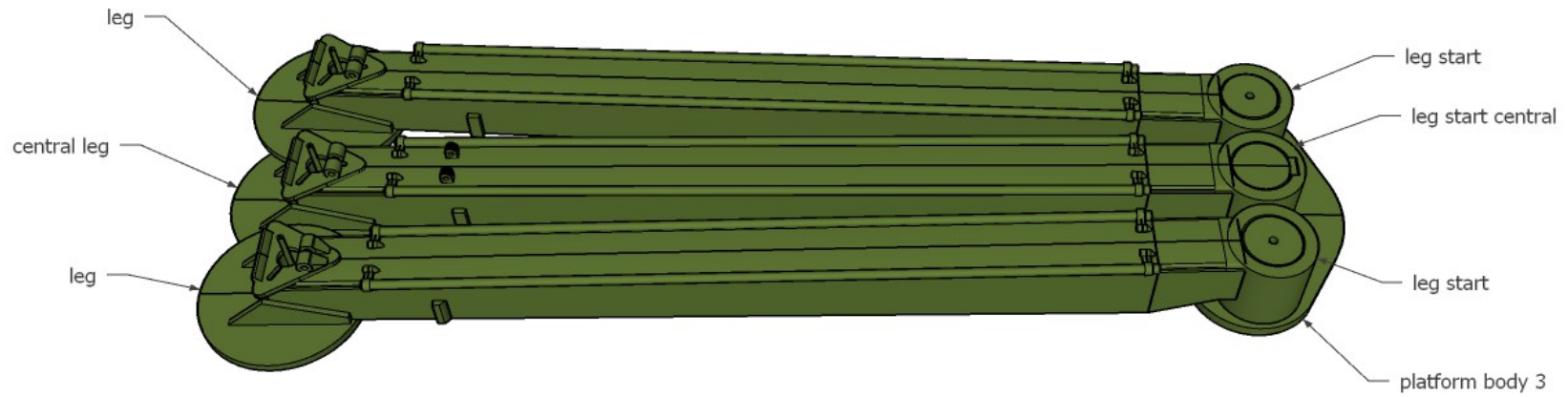

# Step 3

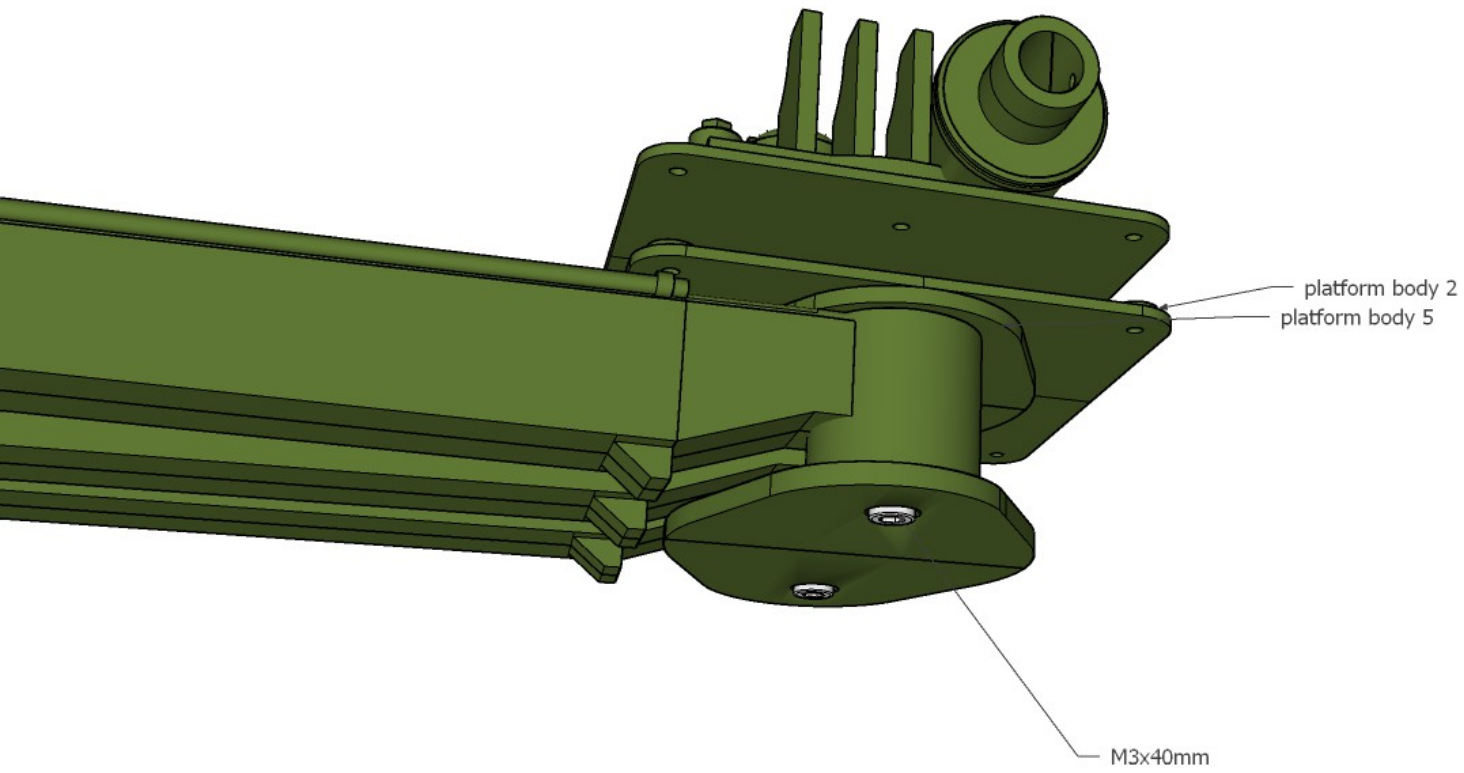

# Step 4

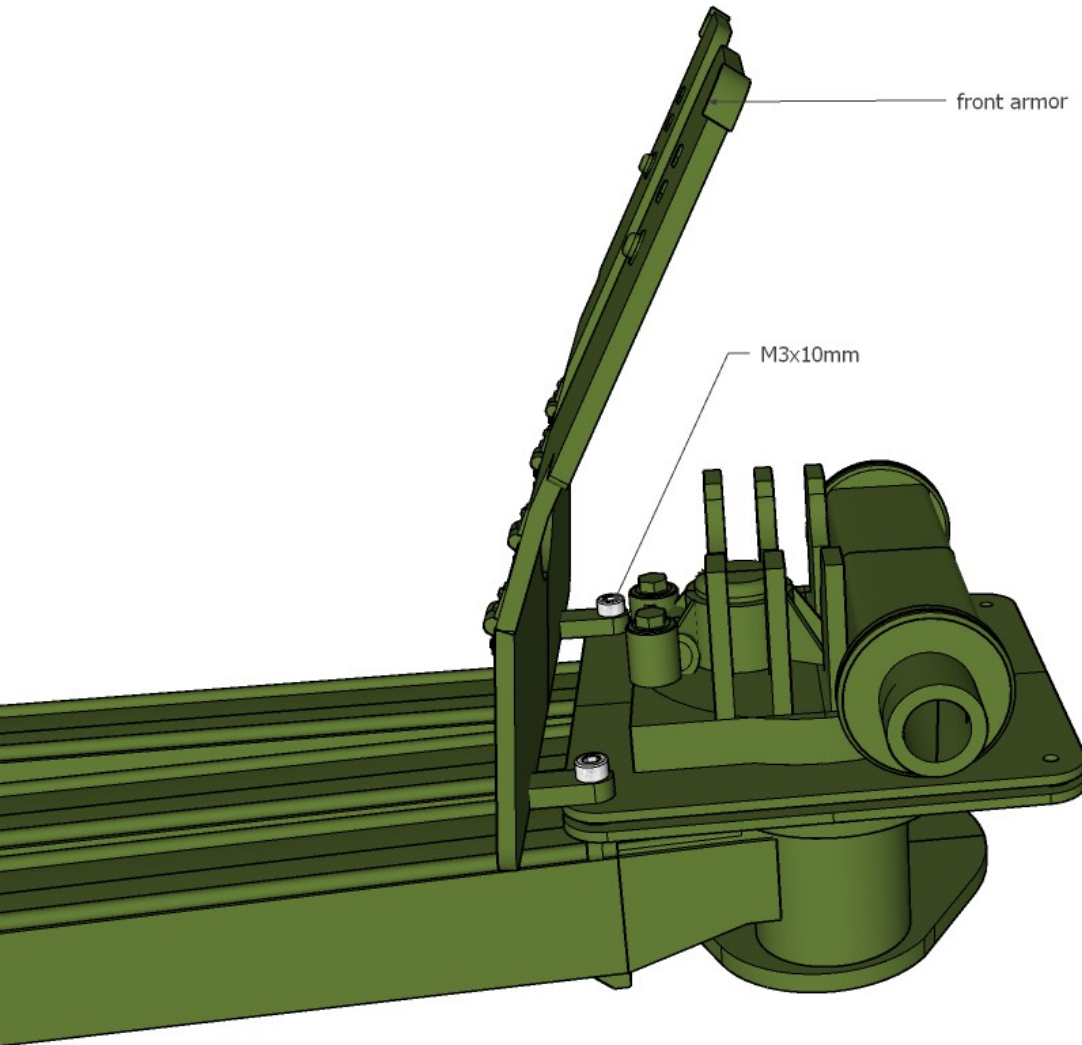

# Step 5

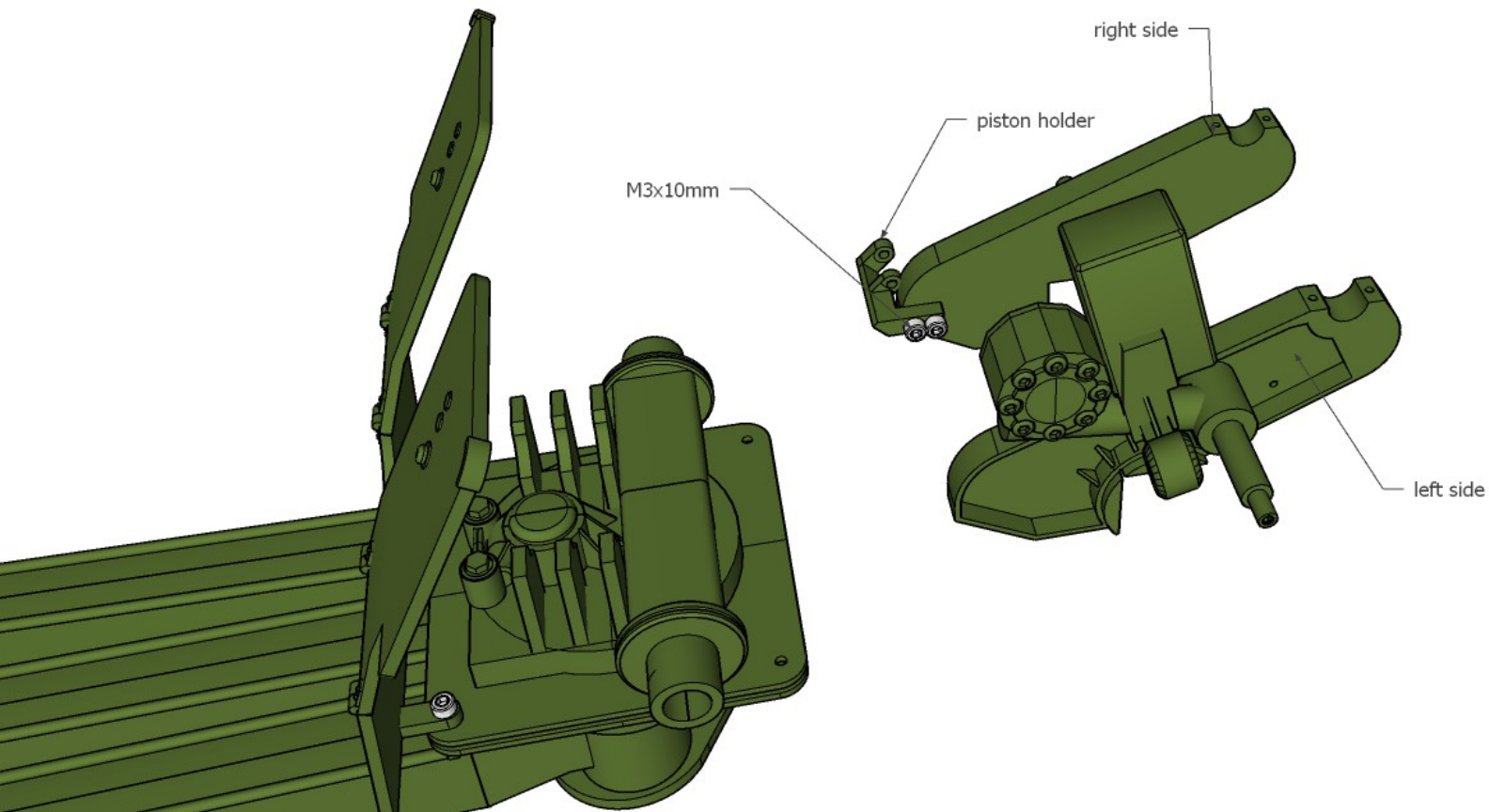

# Step 6

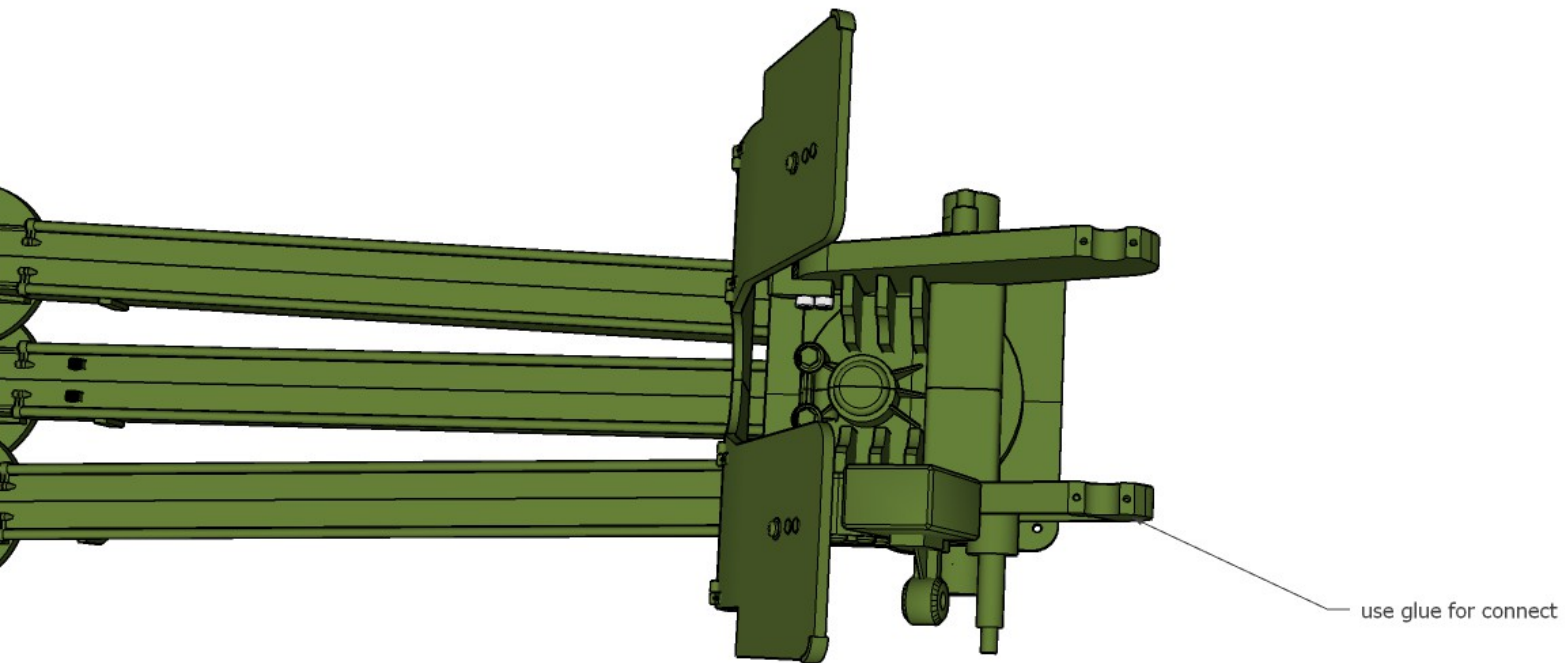

# Step 7

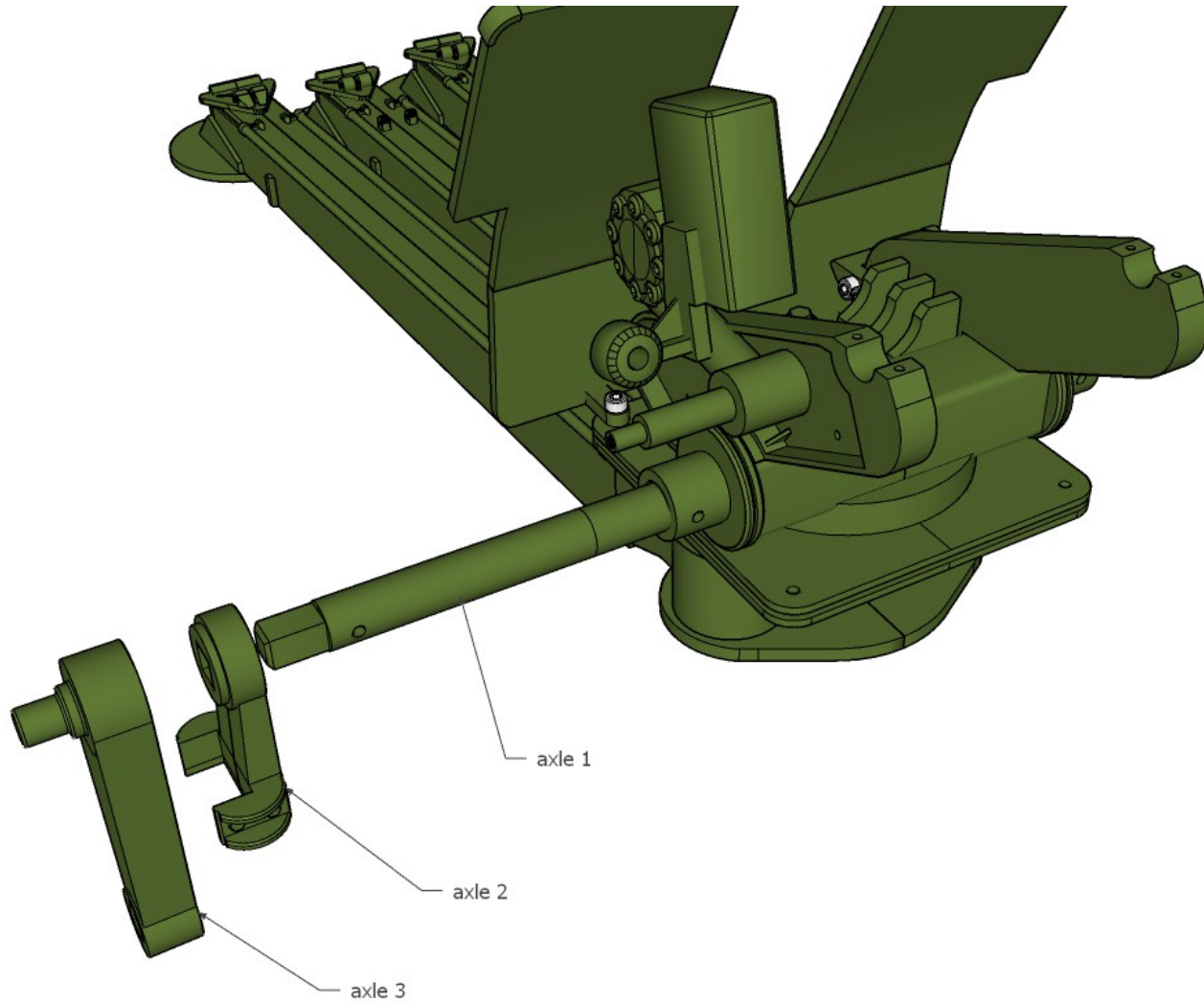



# Step 8

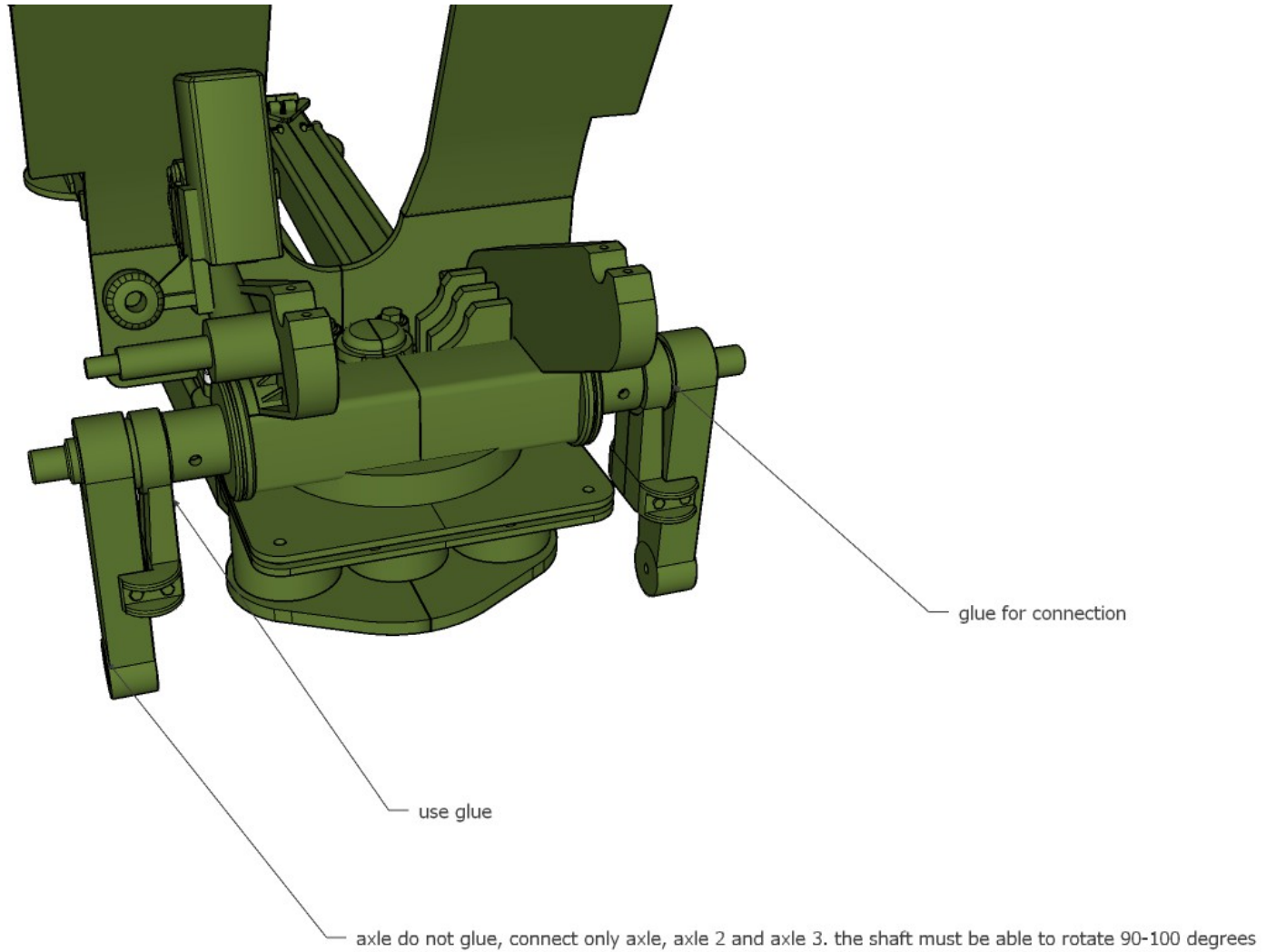

# Step 9

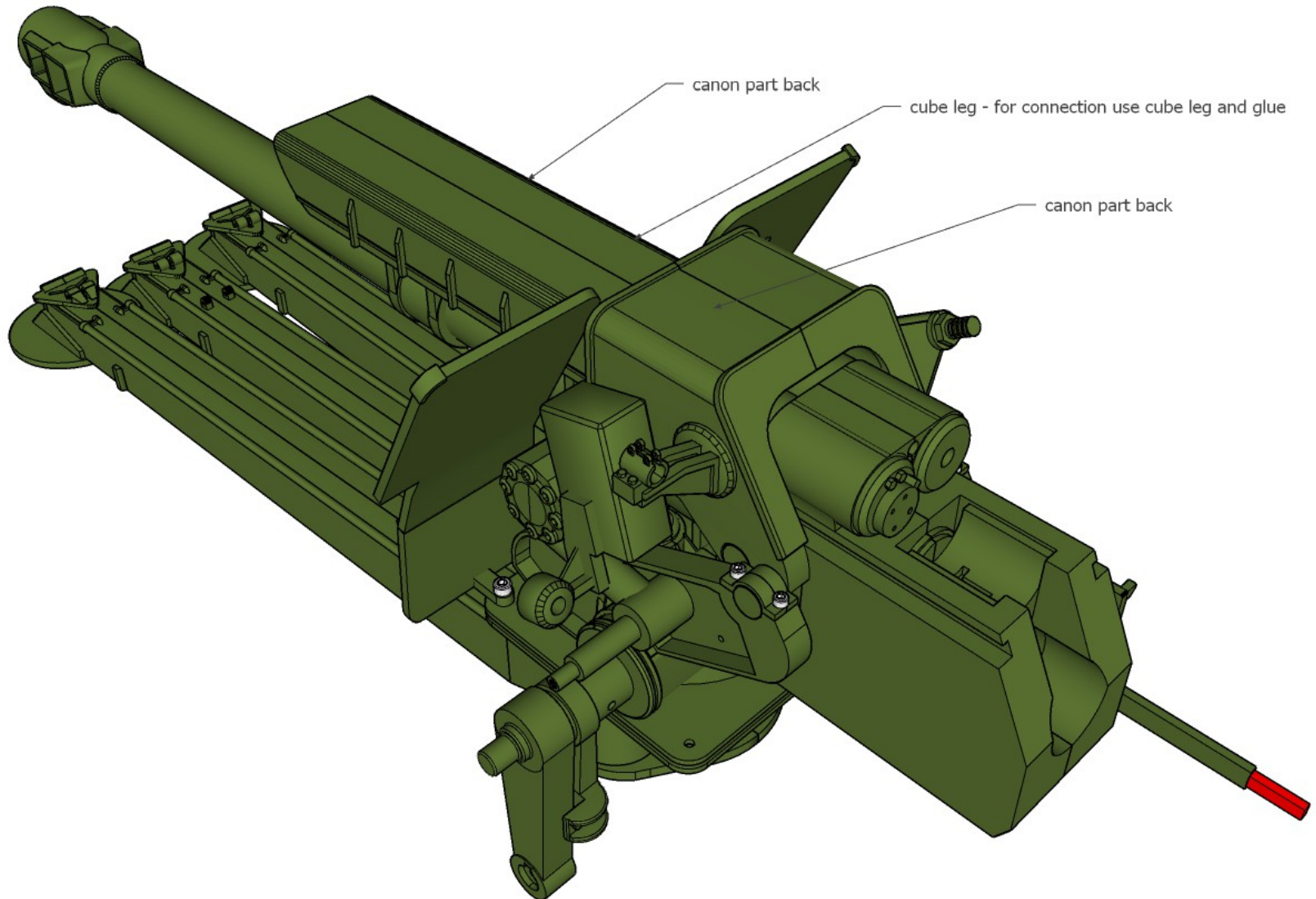

# Step 10

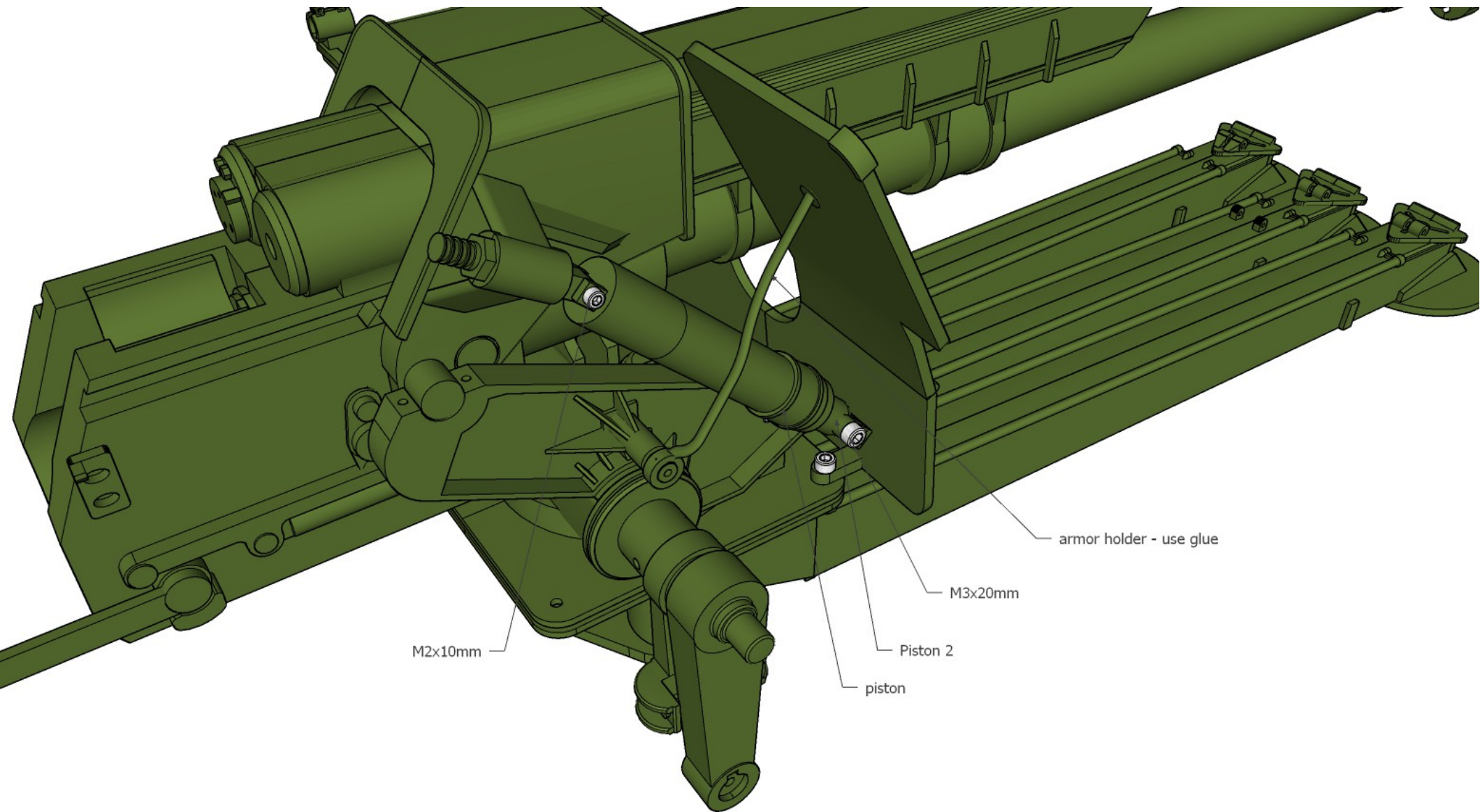

# Step 11

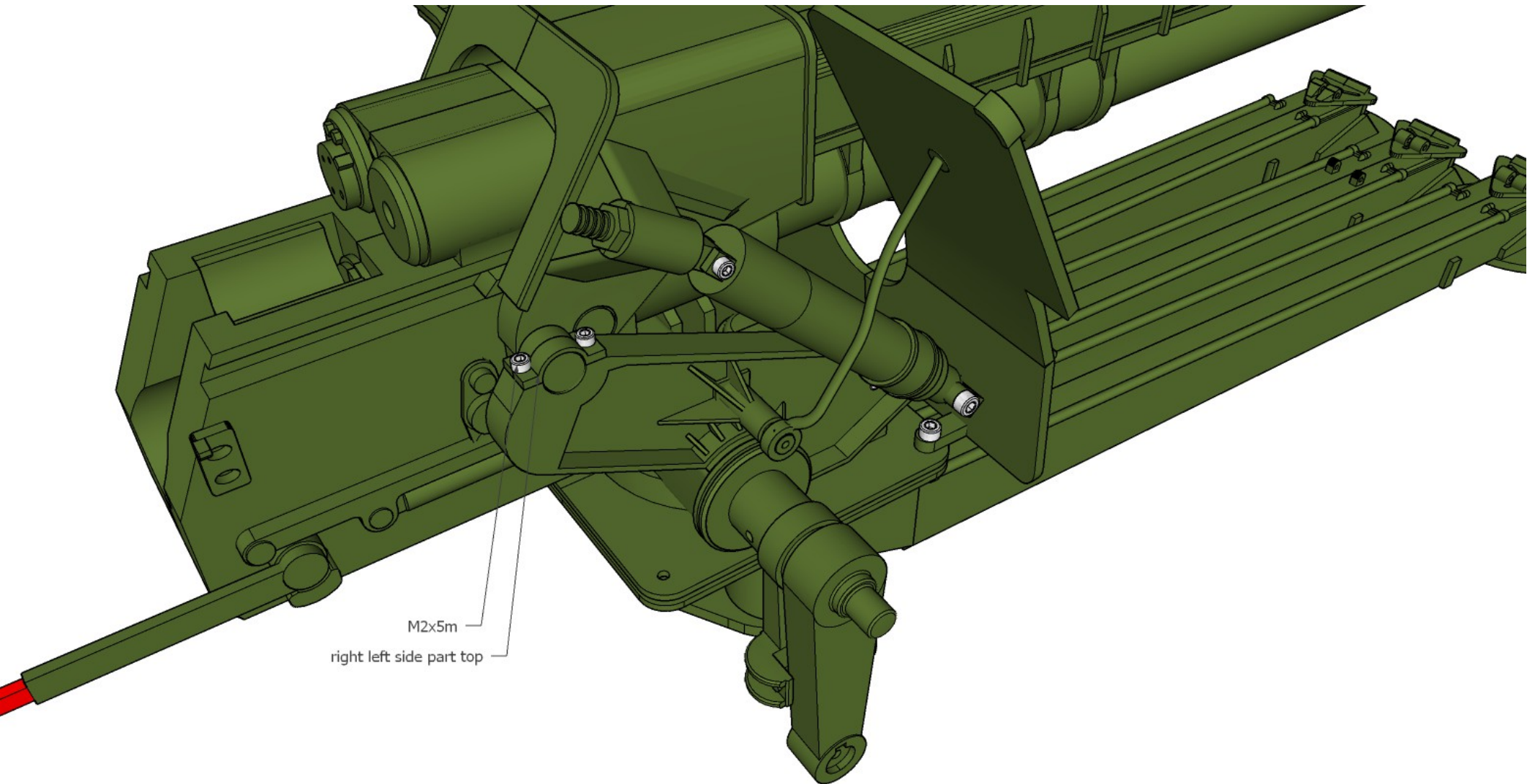

# Step 12

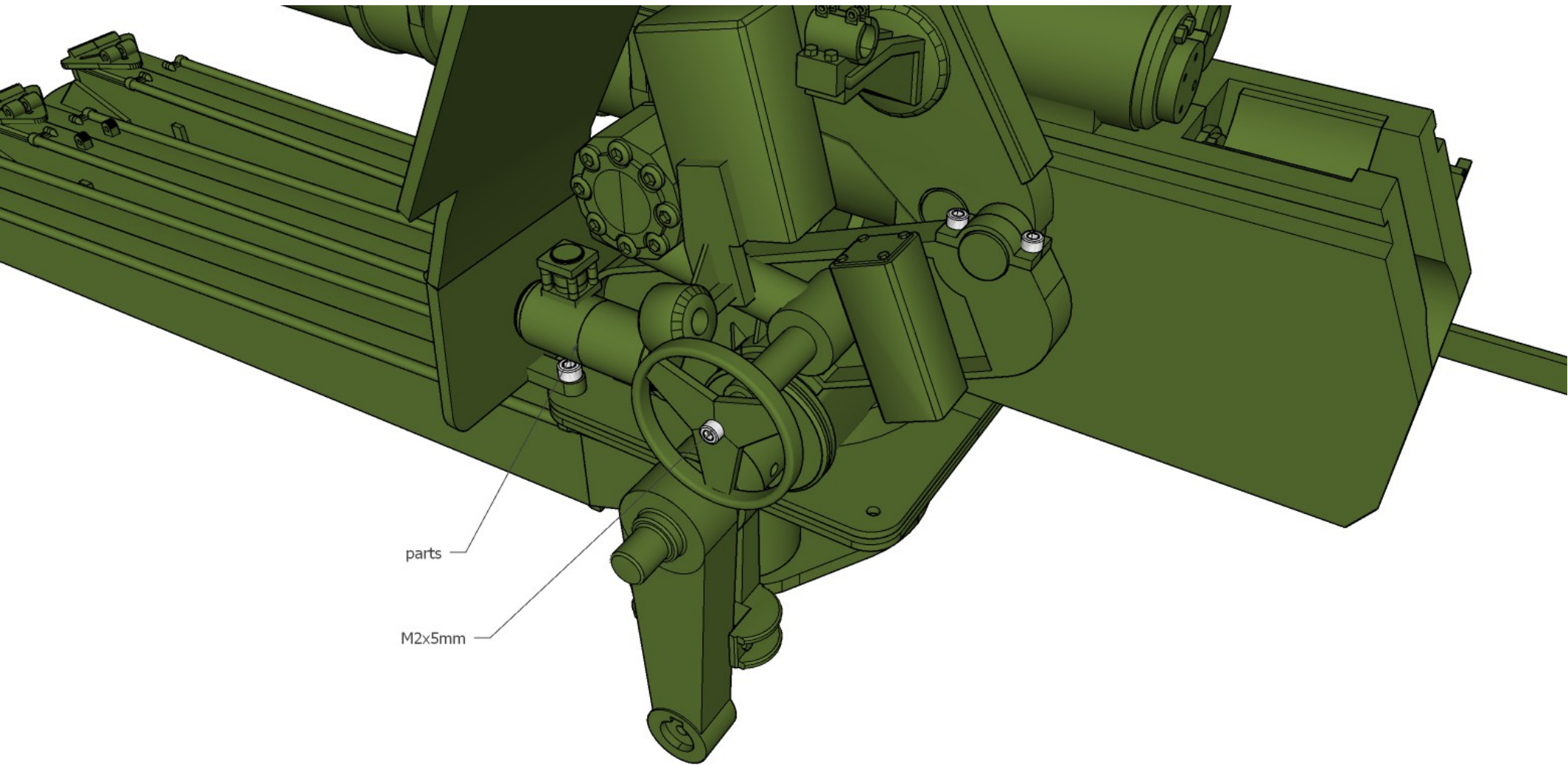

# Step 13

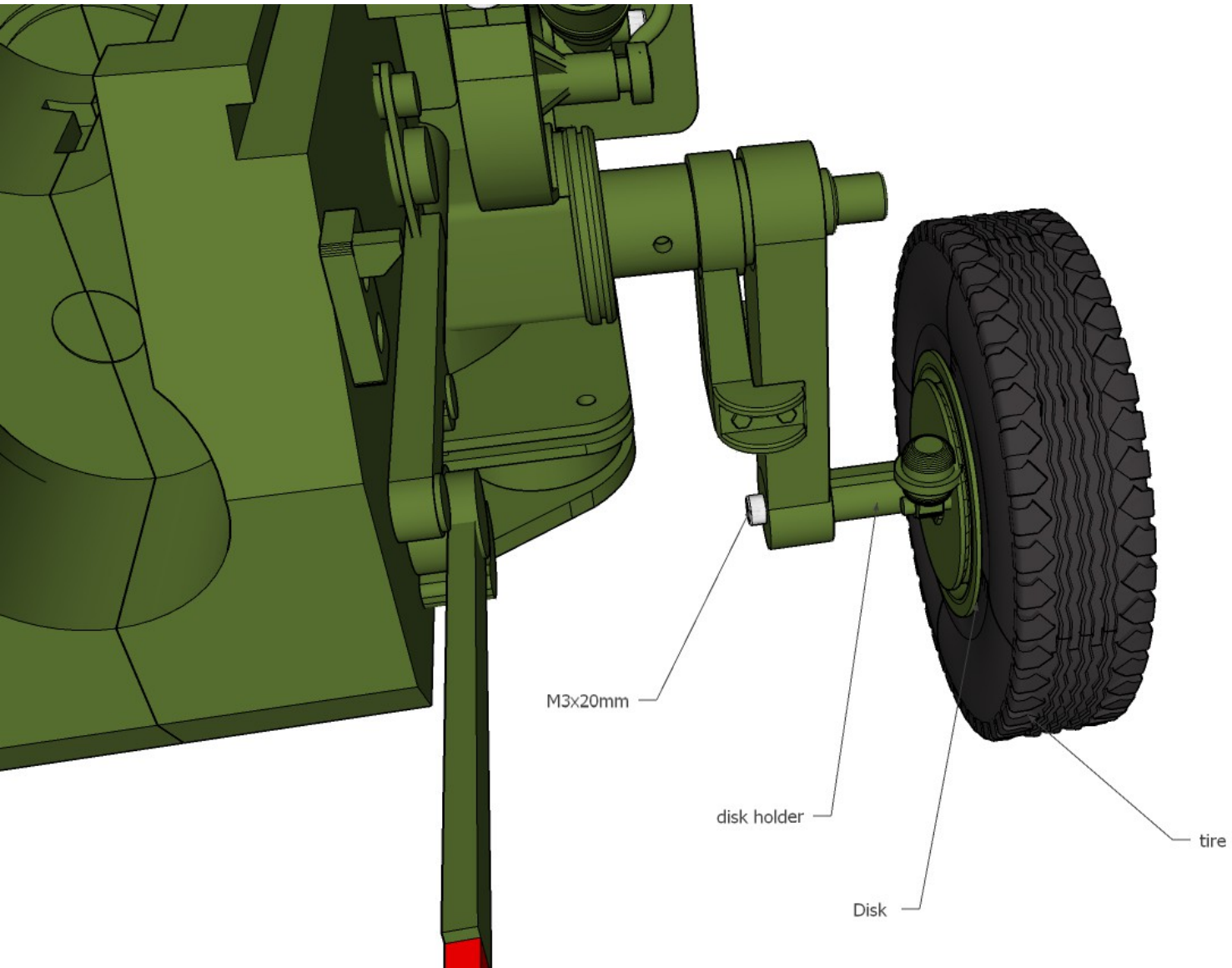

# Step 14

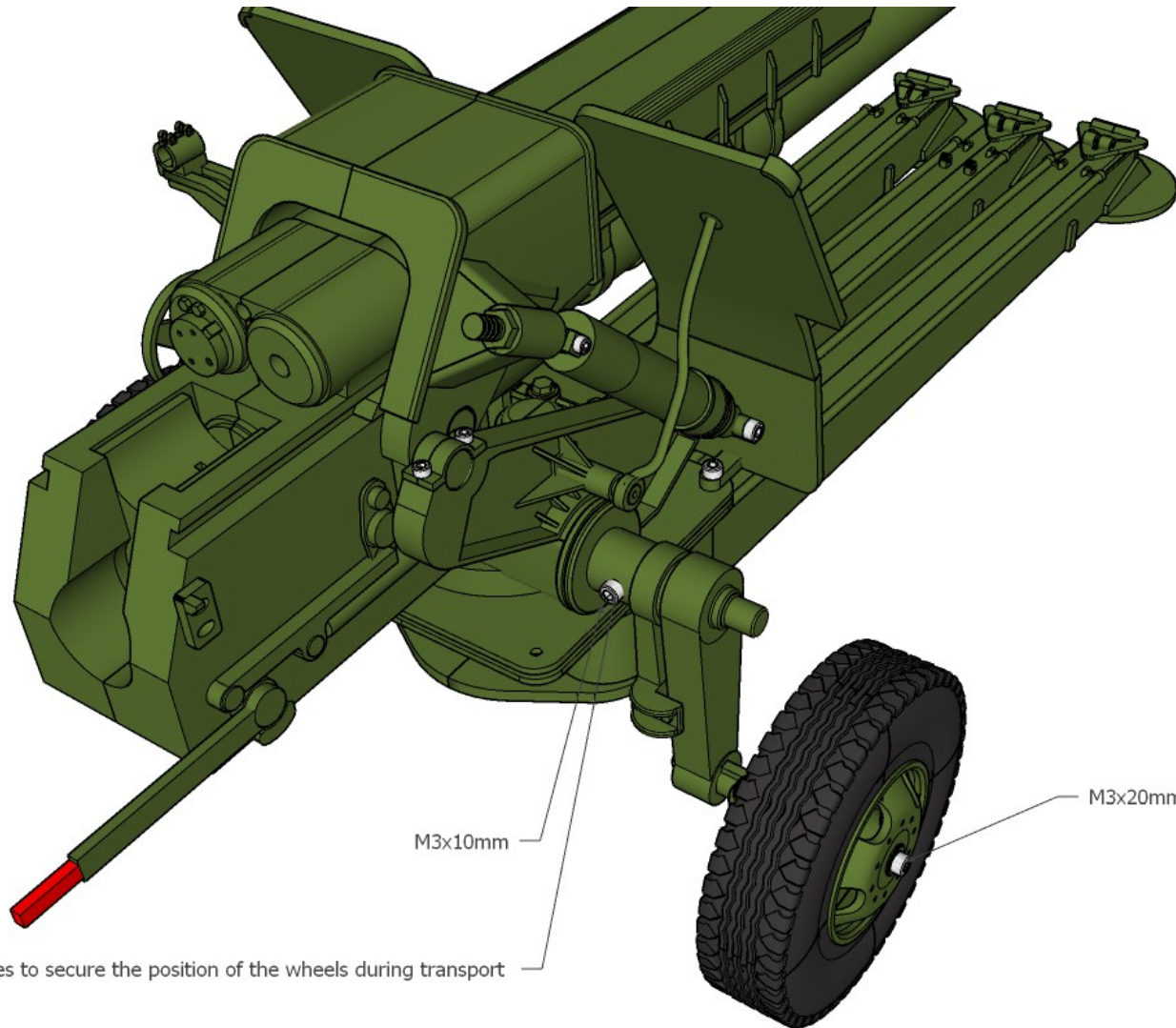

the screw serves to secure the position of the wheels during transport

# Step 15

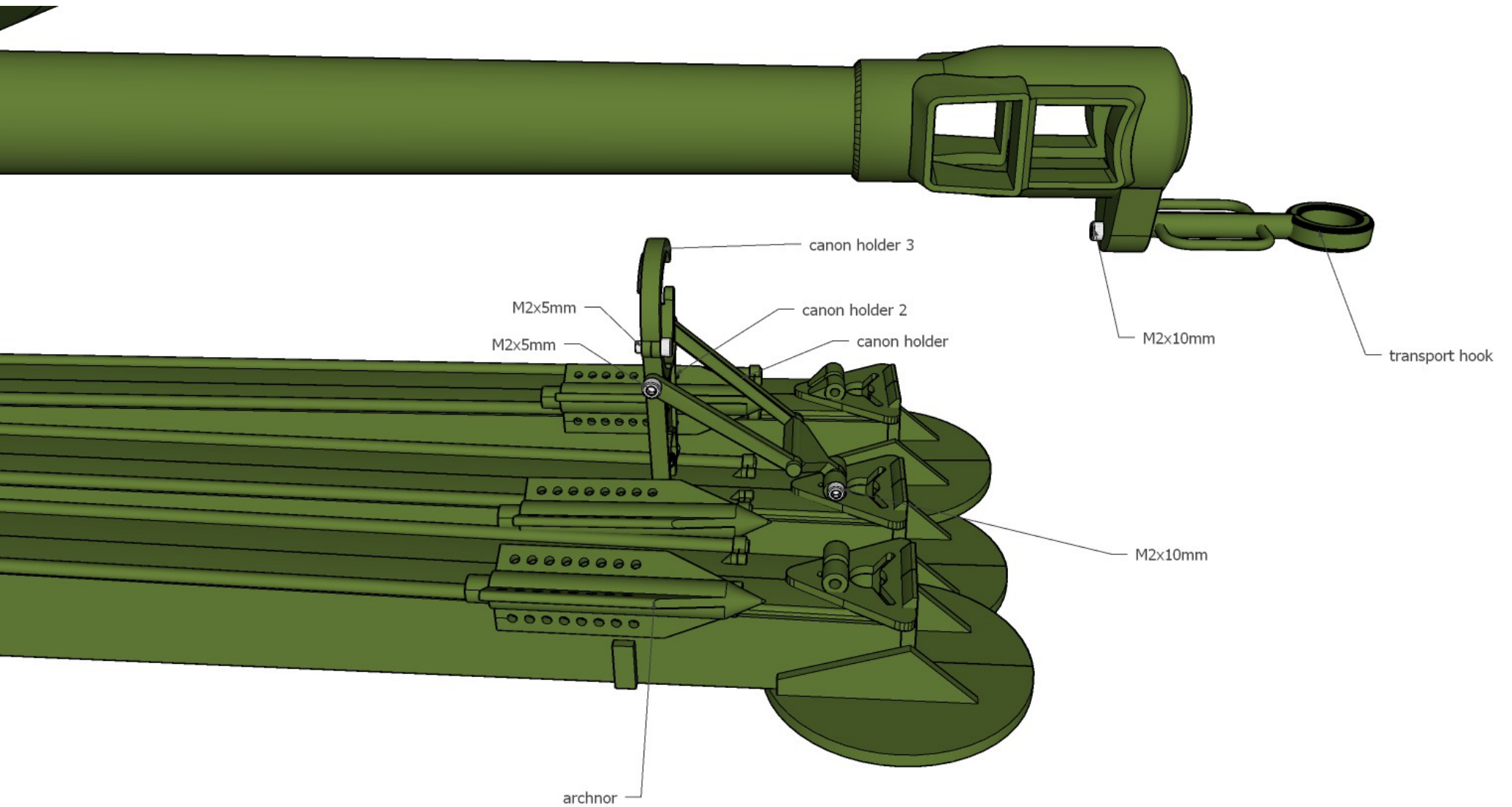



# Step 16

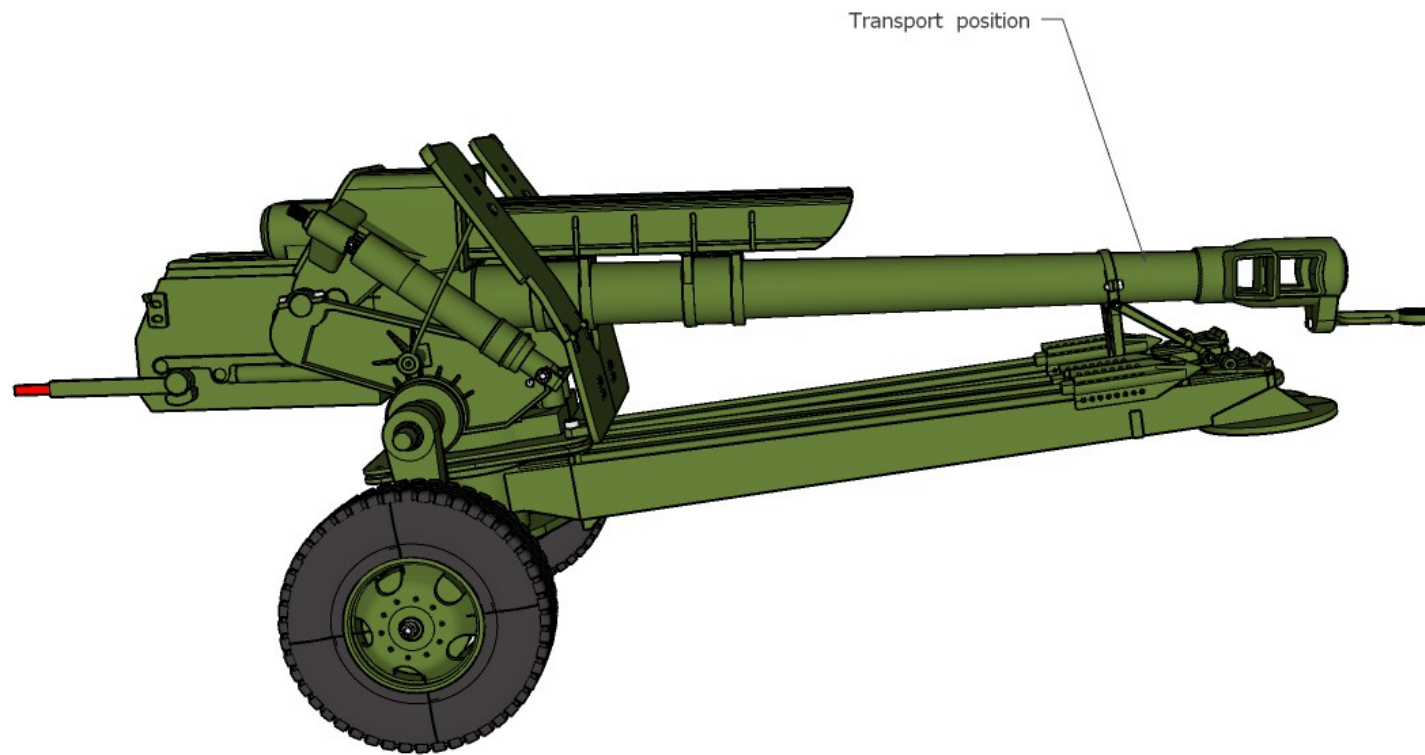

# Step 42

